

Hygienic Cable Glands & Conduit Fittings

Hygienic Glands & Fittings

Stainless steel cable glands and conduit fittings

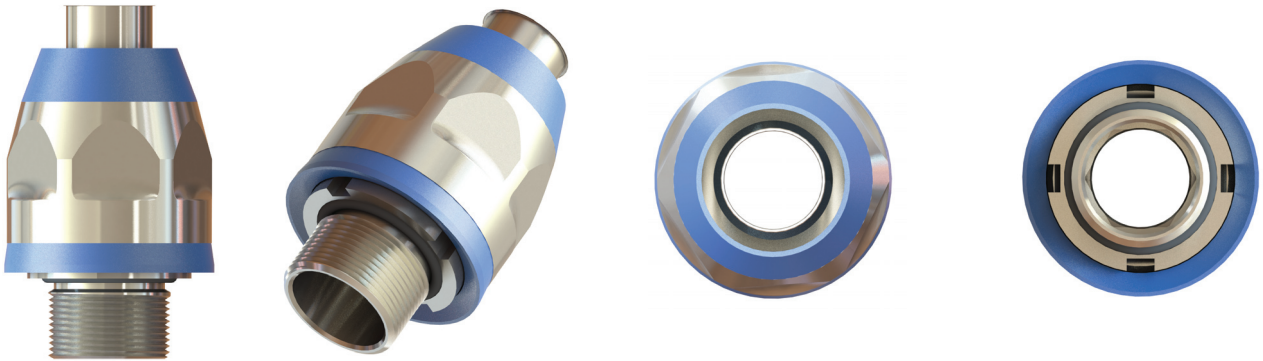

These fittings are made especially for areas of public health, safety, and protection of the environment. Applications range from the food and beverage industry to the chemical processing industry to cleanrooms because the stainless steel cable fittings and gland boast a smooth surface, with all of the threads beneath the cap nut, preventing the depositing of harmful microorganisms.

The benefits of this range include:

- Much easier, faster, and less expensive to clean
- Reduced energy and use of chemicals compared to conventional stainless steel conduit fittings
- Resistant to high-pressure water jet cleaning (IP 69K)
- Greater durability because of superior product quality
- Reliable strain relief due to duplicate cable attachment
- Chemical resistant
- Sustains disinfectant, cleaners, and acids or alkalies
- Suitable for high pressure steam cleaning



Hygienic Cable Glands

CG Clean

Stainless steel hygienic cable gland, standard and EMC

Metric & NPT
Thread

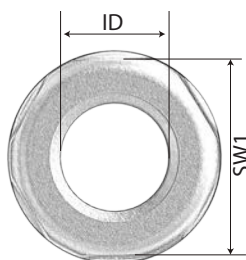
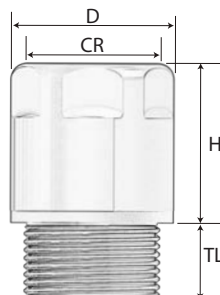

Technical data:	
Material:	Stainless steel 1.4305 (AISI 303)
Seals:	EPDM according to FDA Guideline 21 CFR 177.2600
Clamping Insert:	POM
Protection type:	IP 68 (5 Bar, 30 min.) acc. to EN 60529 IP 69; IP 66
Temperature range:	permanent: -20°C to +100°C intermittent: -40°C to +150°C
Locknut:	Stainless steel
Approvals:	UL, VDE, DNV-GL, NSF, CE

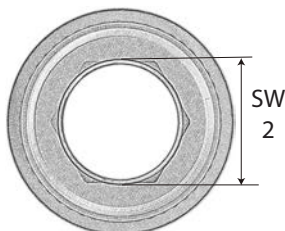

Part Number	Thread Type	Clamping Range Ø min-max (CR)		Wrenching Flats		Inner Diameter (ID)	Outer Diameter (OD)	Thread Length (TL)	Height (H)	Installation Tool
		inches	mm	Cap (SW1) inches	Bottom (SW2) inches					
Metric										
HCGM-12	M12x1.5	0.118 - 0.256	3.0 - 6.5	0.551	0.276	0.264	0.614	0.236	0.925	HCGT-01
HCGM-16	M16x1.5	0.197 - 0.394	5.0 - 10.0	0.709	0.394	0.406	0.795	0.276	1.043	HCGT-02
HCGM-20	M20x1.5	0.236 - 0.472	6.0 - 12.0	0.866	0.512	0.484	0.949	0.315	1.161	HCGT-03
HCGM-25	M25x1.5	0.472 - 0.669	12.0 - 17.0	1.102	0.669	0.681	1.185	0.394	1.280	HCGT-04
Metric: EMC										
HCGE-16	M16x1.5	0.197 - 0.394	5.0 - 10.0	0.709	0.394	0.406	0.795	0.276	1.28	HCGT-02
HCGE-20	M20x1.5	0.236 - 0.472	6.0 - 12.0	0.866	0.512	0.484	0.949	0.315	1.398	HCGT-03
HCGE-25	M25x1.5	0.472 - 0.669	12.0 - 17.0	1.102	0.669	0.681	1.185	0.394	1.614	HCGT-04
NPT										
HCGN-1/4	NPT 1/4"	0.118 - 0.256	3.0 - 6.5	0.709	0.276	0.264	0.795	0.394	0.925	HCGT-01
HCGN-3/8	NPT 3/8"	0.197 - 0.394	5.0 - 10.0	0.866	0.394	0.406	0.949	0.394	1.083	HCGT-02
HCGN-1/2	NPT 1/2"	0.236 - 0.472	6.0 - 12.0	1.102	0.512	0.484	1.185	0.433	1.201	HCGT-03
HCGN-3/4	NPT 3/4"	0.472 - 0.669	12.0 - 17.0	1.378	0.669	0.681	1.496	0.472	1.319	HCGT-04
NPT: EMC										
HCGE-3/8	NPT 3/8"	0.197 - 0.394	5.0 - 10.0	0.866	0.394	0.406	0.949	0.394	1.299	HCGT-02
HCGE-1/2	NPT 1/2"	0.236 - 0.472	6.0 - 12.0	1.102	0.512	0.484	1.185	0.433	1.417	HCGT-03
HCGE-3/4	NPT 3/4"	0.472 - 0.669	12.0 - 17.0	1.378	0.669	0.681	1.496	0.472	1.634	HCGT-04

Locknut included, dimensions are on page N27

EMC Version

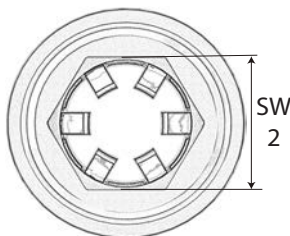
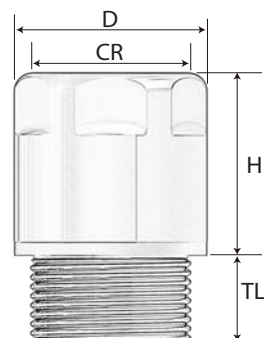

TOOLS FOR INSTALLATION

N
40



Part Number	Thread Type	Allen Screw SW a inches	Spanner Width SW b inches	Height h inches
HCGT-01	M12, NPT 1/4"	0.197	0.276	0.197
HCGT-02	M16, NPT 3/8"	0.236	0.394	0.197
HCGT-03	M20, NPT 1/2"	0.315	0.512	0.315
HCGT-04	M25, NPT 3/4"	0.394	0.669	0.315

Hygienic Conduit Fittings

CF Clean

Stainless steel conduit fittings

Metric & NPT
Thread

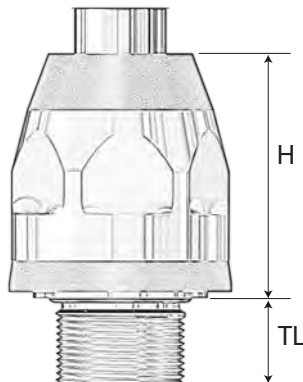

Technical data:	
Material:	Stainless steel 1.4305 (AISI 303)
Seals:	TPE according to FDA Guideline 21 CFR 177.2600
Pressure ring:	PA 6 (Polyamide)
O-ring:	NBR
Ferrule:	Brass
Protection type:	IP 65 IP 66
Temperature range:	
permanent:	-20°C to +100°C
intermittent:	-40°C to +150°C
Locknut:	Stainless steel 1.4305 (AISI 303L)
Approvals:	UL, NSF, CE

Part Number	Thread Type	Spanner Width (SW Cap) inches	Allen Screw (SW a) inches	Crescent Wrench (SW b) inches	Outer Diameter (OD) inches	Thread Length (TL) inches	Height (H) inches	Installation Tool
Metric								
HCFM-16	M16x1.5	1.063	0.433	0.945	1.224	11.5	1.535	HCFT-01
HCFM-20	M20x1.5	1.181	0.551	1.063	1.339	13.0	1.555	HCFT-02
HCFM-25	M25x1.5	1.417	0.748	1.299	1.614	15.0	1.752	HCFT-03
HCFM-32	M32x1.5	1.811	0.984	1.654	2.075	15.0	2.106	HCFT-04
HCFM-40	M40x1.5	2.126	1.26	1.969	2.441	16.0	2.402	HCFT-10
HCFM-50	M50x1.5	2.48	1.417	2.283	2.756	18.0	2.579	HCFT-11
HCFM-63	M63x1.5	3.031	1.89	2.835	3.331	20.0	2.776	HCFT-07
NPT								
HCFN-3/8	NPT 3/8"	1.063	0.433	0.945	1.224	15.3	1.535	HCFT-01
HCFN-1/2	NPT 1/2"	1.181	0.551	1.063	1.339	19.9	1.555	HCFT-02
HCFN-3/4	NPT 3/4"	1.417	0.748	1.299	1.614	20.2	1.752	HCFT-03
HCFN-1	NPT 1"	1.811	0.945	1.654	2.075	25.0	2.106	HCFT-08
HCFN-1-1/4	NPT 1 1/4"	2.126	1.22	1.969	2.441	25.6	2.421	HCFT-09
HCFN-1-1/2	NPT 1 1/2"	2.48	1.417	2.283	2.756	26.0	2.579	HCFT-10
HCFN-2	NPT 2"	3.031	1.811	2.835	3.331	26.9	2.776	HCFT-11

Locknut included, dimensions are on page N27

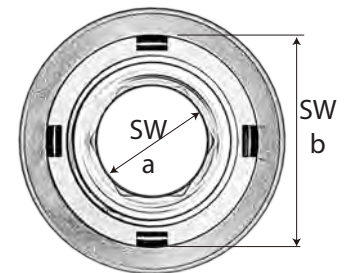
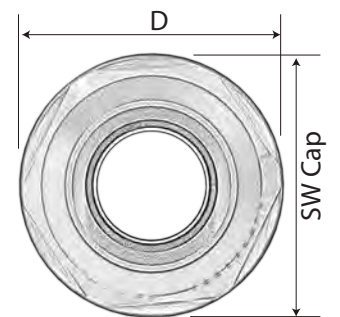

TOOLS FOR INSTALLATION

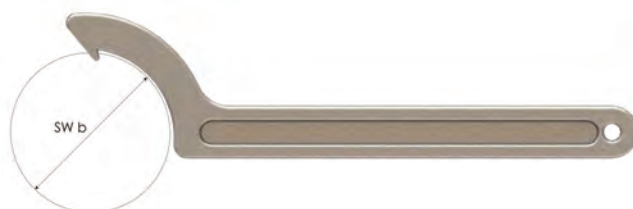
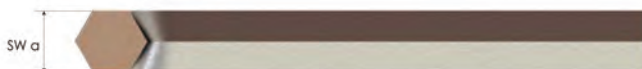

Part Number	Thread Type	Allen Screw SW a inches	Crescent Wrench SW b inches
HCFT-01	M16, NPT 3/8"	0.433	0.945
HCFT-02	M20, NPT 1/2"	0.551	1.063
HCFT-03	M25, NPT 3/4"	0.748	1.299
HCFT-08	NPT 1"	0.945	1.654
HCFT-04	M32	0.984	1.654
HCFT-09	NPT 1 1/4"	1.220	1.969
HCFT-10	M40	1.260	1.969
HCFT-06	M50	1.417	2.283
HCFT-11	NPT 2"	1.811	2.835
HCFT-07	M63	1.890	2.835